

National Pollutant Discharge Elimination System/State Disposal System

MN0022659

Permittee: City of Atwater
Facility name: Atwater Wastewater Treatment Facility
Receiving water: Judicial Ditch 17 - Class 2Bm, 3, 4A, 4B, 5, 6 water
City: Atwater **County:** Kandiyohi
Issuance date: TBD
Expiration date: TBD

The state of Minnesota, on behalf of its citizens through the Minnesota Pollution Control Agency (MPCA), authorizes the Permittee to operate a disposal system at the facility named above and to discharge from this facility to the receiving water named above, in accordance with the requirements of this permit.

The goal of this permit is to reduce pollutant levels in point source discharges and protect water quality in accordance with the U.S. Clean Water Act, Minnesota statutes and rules, and federal laws and regulations.

This permit is effective on the issuance date identified above. This permit expires at midnight on the expiration date identified above.

Signature: *(Type e-Signature)*

This document has been electronically signed.

for the Minnesota Pollution Control Agency

Paul Kimman
Supervisor
South Regional Unit
Municipal Division

Resources

Submit electronic Discharge Monitoring Reports (eDMR) via the MPCA e-Services at:
https://rsp.pca.state.mn.us/TEMPO_RSP/Orchestrate.do?initiate=true

Submit documents electronically to wq.submittals.mpca@state.mn.us. **Note:** The Water quality submittals form located at <https://www.pca.state.mn.us/sites/default/files/wq-wwprm7-71.docx> must be attached.

For eDMR and other permit reporting issues, use the directory listed at the bottom of the Discharge Monitoring Report page: <https://www.pca.state.mn.us/water/discharge-monitoring-reports>

For specific permit requirements, contact your compliance staff: <https://www.pca.state.mn.us/water/wastewater-compliance-and-enforcement-staff-contacts>

For wastewater permit program general questions, contact the MPCA at 651-282-6143 or 800-657-3938, or reference the permit user's manual at <https://www.pca.state.mn.us/sites/default/files/wq-wwtp7-09.pdf>.

Additional guidance and resources are located at: <https://www.pca.state.mn.us/water/wastewater>.

A printable summary of sampling requirements can be found at: <https://www.pca.state.mn.us/water/wastewater-permit-submittal-checklists>.

A printable checklist of submittals can be found at: <https://www.pca.state.mn.us/water/wastewater-permit-submittal-checklists>

Table of Contents

	Page
1. Permitted facility description.....	4
2. Location map of permitted facility.....	5
3. Flow diagram.....	6
4. Groundwater Well Locations	7
5. Summary of stations and station locations.....	8
6. Permit requirements.....	9
7. Submittal action summary	28
8. Limits and monitoring.....	30

DRAFT

1. Permitted facility description

The Atwater Wastewater Treatment Facility (facility) is located at 1100 Kandi-Meeker Road, Atwater, Minnesota 56209, Kandiyohi County.

The existing facility has a controlled discharge from SD 001. The facility is a Class D.

The facility is designed to treat:

- an average wet weather (AWW) flow of 0.200 million gallons per day (MGD); and
- five-day biochemical oxygen demand (BOD₅) strength of 249 milligrams per liter (mg/L).

The two primary cells (also referred to as Cell A and Cell B) have a surface area of 10 acres each and are operated in series. The secondary cell (also referred to as Cell C) has a surface area of 7.5 acres and currently acts as a seepage basin. The facility provides a detention time of 130 days at design flow in Cells A and B.

The primary Cells A and B are large enough to provide adequate detention time at current flows for the wastewater prior to transfer to Cell C. The wastewater transferred to the secondary cell has historically met secondary treatment standards; however, the water evaporates and/or seeps through the bottom of the secondary pond cell.

Changes to the facility may result in an increase in pollutant loading to surface waters or other causes of degradation to surface waters. If a change to the facility will result in a net increase in pollutant loading or other causes of degradation that exceed the maximum loading authorized through conditions specified in the existing permit, the changes to the facility are subject to antidegradation requirements found in Minn. R. 7050.0250 to 7050.0335.

This Permit also complies with Minn. R. 7053.0275 regarding anti-backsliding.

Any point source discharger of sewage, industrial, or other wastes for which a National Pollutant Discharge Elimination System (NPDES) permit has been issued by the MPCA that contains effluent limits more stringent than those that would be established by Minn. R. 7053.0215 to 7053.0265 shall continue to meet the effluent limits established by the permit, unless the permittee establishes that less stringent effluent limits are allowable pursuant to federal law, under section 402(o) of the Clean Water Act, United States Code, title 33, section 1342.

2. Location map of permitted facility

Facility Location Map

MN0022659: Atwater Wastewater Treatment Plant

T119N, R33W, Section 12

Atwater, Kandiyohi County, Minnesota



Map produced by: MPCA Staff, 3/11/2026
Scale: 1:18,750

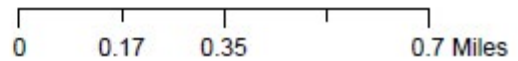

3. Flow diagram

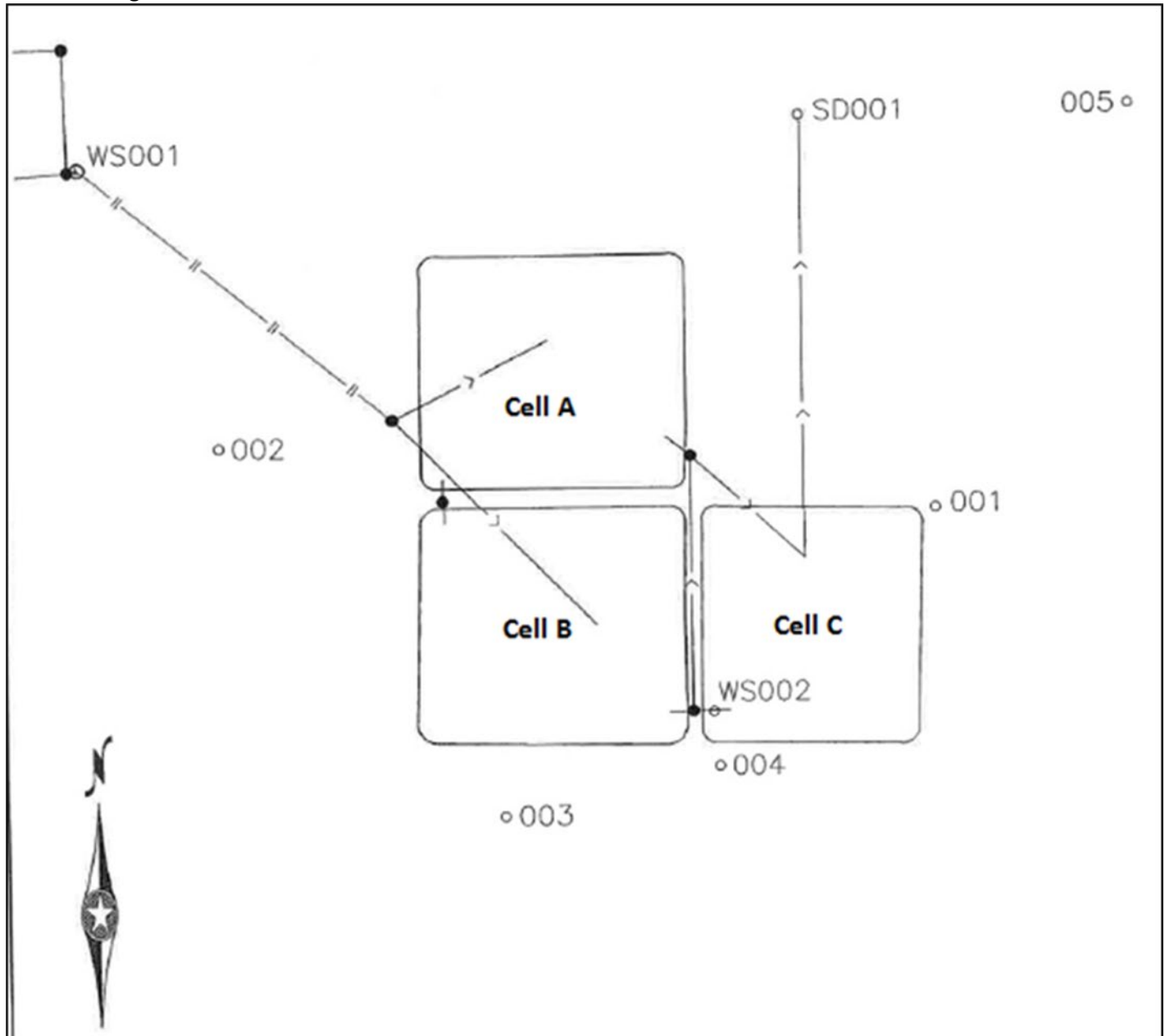

©Bolton & Menk, Inc. 2012, All Rights Reserved

TREATMENT FACILITY SCHEMATIC
ATWATER, MINNESOTA



BOLTON & MENK, INC.
Consulting Engineers & Surveyors
2040 HIGHWAY 12 EAST, WILLMAR, MN 56201 (320) 231-3956
MANKATO, FAIRMONT, SLEEPY EYE, BURNSVILLE, WILLMAR, CHASKA,
RAMSEY, MAPLEWOOD, BAXTER, MINNESOTA & AVES, IOWA

FOR:

4. Groundwater Well Locations



5. Summary of stations and station locations

Station	Type of station	Local name	PLS location
GW 001	Well, Downgradient	Ground Water Well #1	T119N, R33W, S12, NE Quarter
GW 002	Well, Upgradient	Ground Water Well #3	T119N, R33W, S12, NE Quarter
GW 003	Well, Upgradient	Ground Water Well #4	T119N, R33W, S12, NE Quarter
GW 004	Well, Other	Existing Well	T119N, R33W, S12, NE Quarter
GW 005	Well, Downgradient	Ground Water Well #5	T119N, R33W, S12, NE Quarter
SD 001	Effluent To Surface Water	Total Facility Discharge	T119N, R33W, S12, NE Quarter
WS 001	Influent Waste	Influent Waste Stream	T119N, R33W, S12, NE Quarter
WS 002	Intermediate: WW to Land	Effluent to Cell C	T119N, R33W, S12, NE Quarter

6. Permit requirements

GW 001	Well, Downgradient	
		Groundwater Well: Monitoring Requirements
	5.1.1	The Permittee shall submit a monthly DMR : Due by 21 days after the end of each calendar month following permit issuance. [Minn. R. 7001.0150, Subp. 2(B)]
	5.1.2	Sampling Location. [Minn. R. 7001.0150, subp. 2(B)]
	5.1.3	Samples for Station GW 001 shall be taken at the well named Ground Water Well #1. [Minn. R. 7001.0150, subp. 2(B)]
GW 002	Well, Upgradient	
		Groundwater Well: Monitoring Requirements
	5.2.1	The Permittee shall submit a monthly DMR : Due by 21 days after the end of each calendar month following permit issuance. [Minn. R. 7001.0150, Subp. 2(B)]
	5.2.2	Sampling Location. [Minn. R. 7001.0150, subp. 2(B)]
	5.2.3	Samples for Station GW 002 shall be taken at the monitoring well named Ground Water Well #3. [Minn. R. 7001.0150, subp. 2(B)]
GW 003	Well, Upgradient	
		Groundwater Well: Monitoring Requirements
	5.3.1	The Permittee shall submit a monthly DMR : Due by 21 days after the end of each calendar month following permit issuance. [Minn. R. 7001.0150, Subp. 2(B)]
	5.3.2	Sampling Location. [Minn. R. 7001.0150, subp. 2(B)]
	5.3.3	Samples for Station GW 003 shall be taken at the well named Ground Water Well #4. [Minn. R. 7001.0150, subp. 2(B)]
GW 004	Well, Other	
		Groundwater Well: Monitoring Requirements
	5.4.1	The Permittee shall submit a monthly DMR : Due by 21 days after the end of each calendar month following permit issuance. [Minn. R. 7001.0150, Subp. 2(B)]
	5.4.2	Sampling Location. [Minn. R. 7001.0150, subp. 2(B)]
	5.4.3	Samples for Station GW 004 shall be taken at the well named Existing Well. [Minn. R. 7001.0150, subp. 2(B)]
GW 005	Well, Downgradient	
		Groundwater Well: Monitoring Requirements
	5.5.1	The Permittee shall submit a monthly DMR : Due by 21 days after the end of each calendar month following permit issuance. [Minn. R. 7001.0150, Subp. 2(B)]
	5.5.2	Sampling Location. [Minn. R. 7001.0150, subp. 2(B)]
	5.5.3	Samples for Station GW 005 shall be taken at the well named Ground Water Well #5. [Minn. R. 7001.0150, subp. 2(B)]

SD 001	Effluent To Surface Water	
		Surface Discharge: Minor Stabilization Pond Effluent Requirements
	5.6.1	The Permittee shall submit a monthly DMR : Due by 21 days after the end of each calendar month following permit issuance. [Minn. R. 7001.0150, subp. 2(B)]
	5.6.2	Sampling Location. [Minn. R. 7001.0150, subp. 2(B)]
	5.6.3	Samples for Station SD 001 shall be collected from the final outlet control structure. [Minn. R. 7001.0150, subp. 2(B)]
		Facility Specific Requirements
	5.7.4	The permit includes a final total phosphorous water quality based effluent limit (WQBEL) of 0.52 kg/day June - September, calendar month average, at SD 001. The WQBEL is based on achieving a long-term average (multi-summer) of 0.25 kg/day, June - September, which is necessary to achieve river eutrophication standards (RES) in the North Fork Crow River Watershed. Since the long-term average is to be achieved over a multi-summer period the MPCA calculated a monthly limit that accounts for variability of treatment over time. At permit reissuance MPCA will evaluate all available data to ensure RES are met. [Minn. R. 7001]
WS 001	Influent Waste	
		Waste Stream: Stabilization Pond Influent Requirements
	5.8.1	The Permittee shall submit a monthly DMR : Due by 21 days after the end of each calendar month following permit issuance. [Minn. R. 7001.0150, subp. 2(B)]
	5.8.2	Sampling Location. [Minn. R. 7001.0150, subp. 2(B)]
	5.8.3	Samples for Station WS 001 shall be taken at a point that is representative of the total influent flow to the system. [Minn. R. 7001.0150, subp. 2(B)]
WS 002	Intermediate: WW to Land	
		Facility Specific Limit and Monitoring Requirements
	5.9.1	The Permittee shall submit a monthly DMR : Due by 21 days after the end of each calendar month following permit issuance. [Minn. R. 7001.0150, Subp. 2(B)]
	5.9.2	Sampling Location. [Minn. R. 7001.0150, subp. 2(B)]
	5.9.3	Samples for Station WS 002 shall be collected in the transfer between Pond B and Pond C. [Minn. R. 7001.0150, subp. 2(B)]
		Facility Specific Requirements
	5.10.4	Discharge to Cell C. [Minn. R. 7001]
	5.10.5	The entire cell cross-sectional area must be uniformly loaded. [Minn. R. 7001]
	5.10.6	The use of the cell shall cycle in a dosing/resting operational mode. [Minn. R. 7001]
MN0022659	Atwater WWTF	
		Groundwater Station General Requirements
	5.11.1	Sampling Collection and Reporting. [Minn. R. 7001]

5.11.2	The Permittee shall submit monitoring results in accordance with the limits and monitoring requirements for this station. If conditions are such that no sample can be acquired, the Permittee shall report "No Flow" or "No Discharge" on Discharge Monitoring Report (DMR) and shall add a Comments attachment to the DMR detailing why the sample was not collected. [Minn. R. 7001.0150, Subp 2(B)]
5.11.3	Monitoring Wells. [Minn. R. 7001]
5.11.4	The Permittee shall install, maintain, and abandon the groundwater monitoring wells according to the Minnesota Water Well Construction Code, Minn. R. 4725. For example, wells must have a watertight, locked cap or a wrench-tightened, threaded metal cap. Damaged or improperly constructed monitoring wells shall be repaired or properly abandoned and replaced. Information on licensed water well contractors is available from the Minnesota Department of Health. [Minn. R. 4725]
5.11.5	Each monitoring well shall be clearly numbered on the outside of the well with either indelible paint or an inscribed number. [Minn. R. 7001]
5.11.6	The monitoring wells shall be sampled in accordance with Minnesota Pollution Control Agency, Water Quality Division: Sampling Procedures for Ground Water Monitoring Wells, July 1997, Reviewed and re-approved September 2006 or any updates to this document. A copy of this publication is available on the MPCA's website at https://www.pca.state.mn.us/business-with-us/engineering-and-technical-information-for-construction-or-expansion . [Minn. R. 7001]
5.11.7	Grab samples shall be collected at all groundwater monitoring points after stabilization tests are conducted. [Minn. R. 7001]
5.11.8	Prior to well purging and sampling, depths to groundwater shall be measured to the nearest 0.01 foot below the top of the well casing, and groundwater elevations shall be reported to the nearest 0.01 foot above mean sea level. [Minn. R. 7001]
5.11.9	Temperature, specific conductance, and pH shall be reported as the final field measurements from well stabilization. [Minn. R. 7001]
	Surface Discharge Station General Requirements
5.12.13	Surface Discharge Prohibitions. [Minn. R. 7001]
5.12.14	Floating solids or visible foam shall not be discharged in other than trace amounts. [Minn. R. 7001]
5.12.15	Oil or other substances shall not be discharged in amounts that create a visible color film. [Minn. R. 7001]
5.12.16	The Permittee shall install and maintain outlet protection measures at the discharge stations to prevent erosion. [Minn. R. 7001]
5.12.17	Winter Sampling Conditions. [Minn. R. 7001]
5.12.18	The Permittee shall sample flows at the designated monitoring stations including when this requires removing ice to sample the water. If the station is completely frozen throughout a designated sampling month or if unsafe ice conditions exist, the Permittee shall check the "No Discharge/No Flow" box on the eDMR and note the ice conditions in the comments on the eDMR. [Minn. R. 7001]
5.12.19	Chlorine Addition Requirements. [Minn. R. 7001]
5.12.20	If chlorine is added for any purpose, the Permittee shall monitor the discharge for Total Residual Chlorine (TRC) once per day during chlorine usage. The Permittee shall report the monitoring data on the Sample Values and eDMR in months monitoring is required. If chlorine is added for any purpose outside of the effective period listed in the Limits and Monitoring section of the permit, the data should be submitted as a comment on that month's eDMR. The discharge shall not exceed a 0.038 mg/L TRC limit. [Minn. R. 7001]
5.12.21	Sampling Collection and Reporting. [Minn. R. 7001]

5.12.22	The Permittee shall submit monitoring results in accordance with the Limits and Monitoring requirements for this station. If conditions are such that no sample can be acquired, the Permittee shall check "No Discharge/No Flow" on the eDMR and shall add a comment to the eDMR detailing why the sample was not collected. [Minn. R. 7001.0150, subp. 2(B)]
5.12.23	<p>Effluent monitoring for parameters with a frequency of once per half year and an effective period of Jan-Dec shall be taken once during the spring discharge event and once during the fall discharge event. The Permittee must report the spring and fall discharge results on the eDMR that reflects the month the sample was taken.</p> <p>If the half-year monitoring was not completed during a specific month, the Permittee shall leave the boxes blank on the Sample Values and eDMR and include a comment on the eDMR indicating whether half-year monitoring has already been fulfilled or will be completed later during the half year; do not report "0" or "N/A" in the parameter boxes. [Minn. R. 7001]</p>
5.12.24	<p>Effluent monitoring for parameters with a frequency of once per year and an effective period of Jan-Dec may be taken any time during the calendar year. The Permittee must report the monitoring results on the Sample Values in the month the sample was taken.</p> <p>For the months in which a sample was not taken, the Permittee shall leave the boxes blank on the Samples Values and eDMR and include a comment on the eDMR stating that no spring or fall discharge occurred or the monitoring has already been fulfilled; do not report "0" or "N/A" in the parameter boxes. [Minn. R. 7001]</p>
5.12.25	Mercury Limits and Monitoring Requirements. [Minn. R. 7001]
5.12.26	The Permittee is required to sample for total suspended solids (mercury grab sample) at the same time that total mercury and dissolved mercury samples are taken. [Minn. R. 7001]
5.12.27	<p>Total and dissolved mercury samples shall be grab samples and shall be analyzed using the most recent revisions of EPA Methods 1631 and 1669.</p> <p>The Permittee is authorized to use another mercury analytical method that has a reportable level of <0.5 ng/L which allows for low-level sample characterization as long as the method is approved by the EPA and certified by an MPCA accreditation body. [Minn. R. 7001]</p>
5.12.28	<p>Effluent monitoring for mercury with a frequency of once per year and an effective period of Jan-Dec may be taken during either the spring or fall discharge event but must be reported on the month's eDMR of which the sample was taken.</p> <p>For the months in which a sample was not taken, the Permittee shall leave the boxes blank on the Samples Values and eDMR and include a comment on the eDMR stating that no spring or fall discharge occurred or the monitoring has already been fulfilled; do not report "0" or "N/A" in the parameter boxes. [Minn. R. 7001]</p>
5.12.29	Nitrogen Limits and Monitoring Requirements. [Minn. R. 7001]
5.12.30	"Total Nitrogen" with a sample type of "Calculation" is to be reported as the summation of the total Kjeldahl nitrogen and total nitrite plus nitrate nitrogen values. [Minn. R. 7001]

5.12.31	<p>Effluent monitoring of total nitrite plus nitrate nitrogen, total Kjeldahl nitrogen, and total nitrogen with a frequency of once per month shall be collected per discharge event and reported on the Sample Values and eDMR for the month the sample was taken.</p> <p>Effluent monitoring for total ammonia nitrogen and total dissolved solids with a frequency of once per half year shall be collected once during the spring discharge event and once during the fall discharge event. The spring and fall discharge results are to be reported on the month's eDMR of which each sample was taken.</p> <p>If the half-year monitoring was not completed during a specific month, the Permittee shall leave the boxes blank on the Sample Values and eDMR and include a comment on the eDMR indicating whether half-year monitoring has already been fulfilled or will be completed later during the half year; do not report "0" or "N/A" in the parameter boxes. [Minn. R. 7001]</p>
5.12.32	<p>Nitrogen Reduction Strategy Optimization Incentive (Voluntary). [Minn. R. 7001]</p>
5.12.33	<p>A 10 mg/L total nitrogen State Discharge Restriction (SDR) is being proposed for all major municipal wastewater treatment facilities, high concentration minor municipal wastewater treatment facilities, and high concentration industrial dischargers in a MPCA nitrate rulemaking effort. To encourage wastewater treatment facilities to start making achievable nitrogen reductions as soon as possible, the MPCA is proposing in the rulemaking to defer applicability of the SDR limit for one permit cycle for Permittees that have optimized their existing wastewater treatment operations and are able to meet a 15 mg/L total nitrogen limit based on a 12-Month Moving Average for at least 12 months prior to the adoption of a SDR.</p> <p>Note the following:</p> <p>A. The proposed SDR limit is applicable for all major municipal, high concentration minor municipal, and high concentration industrial dischargers. If the Permittee is not currently classified as a major facility but may be prior to SDR adoption, the Permittee may still have the opportunity to participate in this optimization incentive.</p> <p>B. This optimization incentive is dependent on successful rulemaking efforts. If the entire rulemaking or the optimization incentive-portion of the rulemaking are not successful, the SDR limit deferral will not be applicable.</p> <p>C. Once facilities have optimized to reduce their nitrogen concentrations, they must continue operating the facilities in accordance with the optimization efforts.</p> <p>Refer to the accompanying permit documents for additional information regarding the optimization incentive. [Minn. R. 7001]</p>
5.12.34	<p>Phosphorus Limit Types and Calculations. [Minn. R. 7001]</p>
5.12.35	<p>"Calendar Year to Date Total" is a total of all samples taken during one calendar year. To calculate, add all sample values measured from the first of the calendar year to the end date of the current reporting period. When used for loading values (kg/year), first calculate the calendar month total (kg/month) loading by multiplying the calendar month total effluent flow (MG) x the calendar month average concentration x 3.785 conversion factor. Then add all loading values from the first of the calendar year to the end date of the current reporting period. Use the flow from the SD station to calculate this value. If there is no discharge or flow, check the "No Discharge/No Flow" box on the eDMR and don't report any values. [Minn. R. 7001]</p>
	<p>Waste Stream Station General Requirements</p>
5.13.39	<p>Sampling Collection and Reporting. [Minn. R. 7001]</p>

5.13.40	The Permittee shall submit monitoring results in accordance with the limits and monitoring requirements for this station. If conditions are such that no sample can be acquired, the Permittee shall report "No Flow" or "No Discharge" on Discharge Monitoring Report (DMR) and shall add a Comments attachment to the DMR detailing why the sample was not collected. [Minn. R. 7001.0150, Subp 2(B)]
5.13.41	Influent monitoring for parameters with a frequency of once per quarter and an effective period of Mar, Jun, Sep, Dec can be sampled any time during that calendar quarter. The Permittee must report the monitoring results on the Sample Values in the month they conducted the monitoring and on the eDMR at the end of the quarter. (e.g. The Permittee shall report the sample for the first calendar quarter of Jan-Mar on the Sample Values in the month the sample is collected and on the March eDMR). [Minn. R. 7001]
5.13.42	Nitrogen Limits and Monitoring Requirements. [Minn. R. 7001]
5.13.43	"Total Nitrogen" with a sample type of "Calculation" is to be reported as the summation of the total Kjeldahl nitrogen and total nitrite plus nitrate nitrogen values. [Minn. R. 7001]
	Pond System
5.14.47	Bypass Structures. [Minn. R. 7001]
5.14.48	All structures capable of bypassing the treatment system shall be manually controlled and kept locked at all times. [Minn. R. 7001.0150, subp. 3(F)]
5.14.49	Sanitary Sewer Extension Permit. [Minn. R. 7001]
5.14.50	The Permittee may be required to obtain a sanitary sewer extension permit from the MPCA for any addition, extension, or replacement to the sanitary sewer. If a sewer extension permit is required, construction may not begin until plans and specifications have been submitted and a written permit is granted except as allowed in Minn. Stat. 115.07, subd. 3(b). [Minn. R. 7001.0150, subp. 3(F)]
5.14.51	Operator Certification. [Minn. R. 7001]
5.14.52	The Permittee shall provide a Class D state certified operator who maintains direct responsibility of the operation, maintenance, and testing functions required to ensure compliance with the terms and conditions of this permit. [Minn. R. 9400.0400, subp. 1(A)]
5.14.53	If the Permittee chooses to meet operator certification requirements through a contractual agreement, the Permittee shall provide a copy of the contract to the MPCA, WQ Submittals Center. The contract shall include: A. The certified operator's name, certificate number, company name (if appropriate), and the period covered by the contract and provisions for renewal; B. The duties and responsibilities of the certified operator; C. The duties and responsibilities of the Permittee; and D. Provisions for notifying the MPCA 30 days in advance of termination if the contract is terminated prior to the expiration date. [Minn. R. 9400.0400, subp. 1(A)]
5.14.54	The Permittee shall notify the MPCA within 30 days of a change in operator certification or contract status. [Minn. R. 7001.0150, subp. 3(F)]
5.14.55	Acceptable Discharge Periods. [Minn. R. 7001]
5.14.56	Acceptable stabilization pond discharge periods are March 1 through June 15 (spring discharge) and September 15 through December 31 (fall discharge). [Minn. R. 7001.0150, subp. 3(F)]
5.14.57	If the MPCA requires a more restrictive or a custom discharge period to protect water quality, it will be listed in the Limits and Monitoring table of this permit. [Minn. R. 7001]
5.14.58	Discharges Outside Acceptable Discharge Periods. [Minn. R. 7001]

5.14.59	The Permittee shall refer to the Stabilization Pond Discharge Guidance located on the MPCA's website at https://www.pca.state.mn.us/business-with-us/wastewater-operator-resources for any discharge outside of the acceptable discharge periods. In addition, the Permittee shall notify the MPCA of the potential noncompliance prior to discharge. The Permittee shall call the appropriate MPCA regional office or assigned Compliance and Enforcement staff and indicate that the call is for notification of a pond discharge outside of acceptable discharge periods. [Minn. R. 7001.0150, subp. 3(F)]
5.14.60	The Permittee shall allow an adequate dilution ratio for any discharge outside of acceptable discharge periods or to an ice covered receiving water. If an adequate dilution ratio is not available, the Permittee shall monitor the receiving water as specified in the Stabilization Pond Discharge Guidance. [Minn. R. 7001.0150, subp. 3(F)]
5.14.61	The Permittee shall submit an eDMR for any discharge outside of acceptable discharge periods or to an ice covered receiving water. The Permittee shall also submit a Discharge Evaluation Report located on the MPCA's website at https://www.pca.state.mn.us/business-with-us/wastewater-operator-resources . [Minn. R. 7001.0150, subp. 3(F)]
5.14.62	Pond Discharge Rate. [Minn. R. 7001]
5.14.63	The discharge rate shall be limited so as not to create a shock load on the receiving waters, disturb the pond bottom sediment in the area of the intake of the outfall structure or flood downstream properties. If the drawdown rate should exceed six inches per day, the Permittee shall call the appropriate MPCA regional office or assigned Compliance and Enforcement staff and indicate that the call is for notification of a pond discharge outside of acceptable discharge periods. [Minn. R. 7001.0150, subp. 3(F)]
5.14.64	Limit Calculation Basis. [Minn. R. 7001]
5.14.65	Effluent limitations for this permit have been assigned based upon the assumption that the pond will be discharged no more than six inches per day and that the receiving waters exhibit favorable flow and reaeration characteristics during the acceptable discharge periods. [Minn. R. 7001.0150, subp. 3(F)]
5.14.66	Pre-discharge Sampling. [Minn. R. 7001]
5.14.67	<p>Prior to discharge, the Permittee shall:</p> <ul style="list-style-type: none"> A. Take composite samples from four sides of the pond; B. Analyze the composite sample for permitted parameters; C. Collect and analyze this sample no more than two weeks prior to the beginning of the discharge; D. Collect and analyze dissolved oxygen and pH samples as field tests no more than 24 hours prior to the beginning of the discharge; and E. Obtain and analyze additional pre-discharge samples prior to discharge if more than two weeks pass prior to the beginning of discharge. [Minn. R. 7001.0150, subp. 3(F)]
5.14.68	If pre-discharge sample results indicate exceedances of one or more of the effluent limitations, the Permittee shall call the appropriate MPCA regional office or assigned Compliance and Enforcement staff and indicate that the call is for notification of a pond discharge outside of acceptable discharge periods. [Minn. R. 7001.0150, subp. 3(F)]
5.14.69	Pond Observations. [Minn. R. 7001]
5.14.70	<p>The Permittee shall inspect the pond system at a minimum frequency of once per week and shall:</p> <ul style="list-style-type: none"> A. Measure pond water depth; B. Estimate the coverage of aquatic plants, floating mats, and ice cover on the surface of the ponds; and C. Note odors, the condition of the dikes, and the presence of rodents. <p>The Permittee shall maintain records of these weekly inspections for the last three years and submit the results as an attachment to the eDMR. [Minn. R. 7001.0150, subp. 3(F)]</p>

		Pretreatment: Nondelegated Requirements
	5.15.74	Definitions. [Minn. R. 7049]
	5.15.75	"Individual Control Mechanism" means a document, such as an agreement or permit, which imposes limitations or requirements on an individual industrial user of the publicly owned treatment works (POTW). [Minn. R. 7049]
	5.15.76	"Significant Industrial User" (SIU) means any industrial user that: A. Is subject to Categorical Pretreatment Standards, as defined in Minn. R. 7049.0120, subp. 5; B. Discharges 25,000 gallons per day or more of process wastewater, excluding sanitary, noncontact cooling, or boiler blowdown wastewater, to the POTW; C. Contributes a process wastewater containing five percent or more of the flow or load of any pollutant of concern to the POTW; or D. Is designated as significant by the Permittee or the MPCA on the basis that the industrial user has a reasonable potential to adversely impact the POTW's operation or violate any pretreatment standard or requirement. [Minn. R. 7049]
	5.15.77	Permittee Responsibility to Control Users. [Minn. R. 7049]
	5.15.78	It is the Permittee's responsibility to regulate the discharge from users of its POTW. The Permittee shall prevent any pass through of pollutants or any inhibition or disruption of the Permittee's POTW, its treatment processes, or its sludge processes or disposal that contribute to the violation of the conditions of this permit or any federal or state law or regulation limiting the release of pollutants from the POTW. [Minn. R. 7049]
	5.15.79	The Permittee shall prohibit the discharge of the following to its POTW: A. Pollutants that create a fire or explosion hazard, including any discharge with a flash point less than 60 degrees C (140 degrees F); B. Pollutants that will cause corrosive structural damage to the POTW, including any waste stream with a pH of less than 5.0; C. Solid or viscous pollutants which would obstruct flow; D. Any pollutant, including oxygen-demanding pollutants such as biochemical oxygen demand, released at a flow rate or pollutant concentration that will cause interference or pass-through; E. Heat that would inhibit biological activity, including any discharge that would cause the temperature of the waste stream at the POTW treatment plant headwork's to exceed 40 degrees C (104 degrees F); F. Petroleum oil, nonbiodegradable cutting oil, or products of mineral oil origin in amounts that would cause interference or pass-through; and G. Pollutants that produce toxic gases, vapors, or fumes that may endanger the health or safety of workers. [Minn. R. 7049]
	5.15.80	The Permittee shall prohibit new discharges of non-contact cooling waters unless there is no cost effective alternative. Existing discharges of non-contact cooling water to the Permittee's POTW shall be eliminated, where elimination is cost effective, or where an infiltration/inflow analysis and sewer system evaluation survey indicates the need for such removal. [Minn. R. 7049]
	5.15.81	If the Permittee accepts trucked-in wastes, the Permittee shall evaluate the trucked-in wastes prior to acceptance in the same manner as it monitors sewered wastes. The Permittee shall accept trucked-in wastes only at specifically designated points. [Minn. R. 7049]

5.15.82	<p>Pollutant of concern means a pollutant that is or may be discharged by an industrial user that is or reasonably should be of concern on the basis that it may cause the Permittee to violate any permit limits on the release of pollutants. The following pollutants shall be evaluated to determine if they should be pollutants of concern:</p> <p>A. Pollutants limited in this permit; B. Pollutants for which monitoring is required in this permit; C. Pollutants that are likely to cause inhibition of the Permittee's POTW; D. Pollutants which may interfere with sludge disposal; and E. Pollutants for which the Permittee's POTW has limited capacity. [Minn. R. 7049]</p>
5.15.83	<p>Control of Significant Industrial Users. [Minn. R. 7049]</p>
5.15.84	<p>The Permittee shall impose pretreatment requirements on SIUs to ensure compliance with all applicable effluent limitations and other requirements set forth in this permit or any federal or state law or regulation limiting the release of pollutants from the POTW. These requirements shall be applied to SIUs by means of an individual control mechanism. [Minn. R. 7049]</p>
5.15.85	<p>The Permittee shall not knowingly enter into an individual control mechanism with any user that would allow the user to contribute an amount or strength of wastewater that would cause violation of any limitation or requirement in the permit, or any applicable federal, state, or local law or regulation. [Minn. R. 7049]</p>
5.15.86	<p>Monitoring of Significant Industrial Users. [Minn. R. 7049]</p>
5.15.87	<p>The Permittee shall obtain specific information from SIUs on the quality and quantity of the SIU's discharges to the Permittee's POTW. Except where specifically requested by the Permittee and approved by the MPCA, this information shall be obtained by means of representative monitoring conducted by the Permittee or by the SIU under requirements imposed by the Permittee in the SIU's individual control mechanism. Monitoring performed to comply with this requirement shall include all pollutants for which the SIU is significant and shall be done at a frequency commensurate with the significance of the SIU. [Minn. R. 7049]</p>
5.15.88	<p>Reporting and Notifications. [Minn. R. 7049]</p>
5.15.89	<p>The Permittee shall submit a pretreatment annual report : Due by 31 days after the end of each calendar year following permit issuance if a SIU discharges to the POTW during a given calendar year. [Minn. R. 7049]</p>
5.15.90	<p>The Permittee shall submit the Pretreatment Annual Report found on the MPCA's website at https://www.pca.state.mn.us/business-with-us/wastewater-pretreatment or shall provide equivalent information. [Minn. R. 7049]</p>
5.15.91	<p>The Permittee shall submit the Pretreatment Annual Report to the MPCA, WQ Submittals Center. [Minn. R. 7049]</p>
5.15.92	<p>The Permittee shall notify the MPCA in writing of any of the following:</p> <p>A. Any SIU of the Permittee's POTW which has not been previously disclosed to the MPCA; B. Anticipated or actual changes in the volume or quality of discharge by an industrial user that could result in the industrial user becoming an SIU as defined in this section; or C. Anticipated or actual changes in the volume or quality of discharges by a SIU that would require changes to the SIU's required local limits.</p> <p>This notification shall be submitted within 30 days of identifying the industrial user as a SIU. Where changes are proposed, they shall be submitted prior to changes being made. [Minn. R. 7049]</p>

5.15.93	<p>Upon notifying the MPCA of a SIU or change in a SIU discharge as required above, the Permittee shall submit the following information using the forms found on the MPCA's website at https://www.pca.state.mn.us/water/wastewater-pretreatment or in a comparable format:</p> <p>A. The identity of the SIU and a description of the SIU's operation and process; B. A characterization of the SIU's discharge; C. The required local limits that will be imposed on the SIU; D. A technical justification of the required local limits; and E. A plan for monitoring the SIU which is consistent with monitoring requirements in this section. [Minn. R. 7049]</p>
5.15.94	<p>In addition, the Permittee shall, upon request, submit the following to the MPCA for approval:</p> <p>A. Additional information on the SIU, its processes, and discharge; B. A copy of the individual control mechanism used to control the SIU; C. The Permittee's legal authority to be used for regulating the SIU; and D. The Permittee's procedures for enforcing the requirements imposed on the SIU. [Minn. R. 7049]</p>
5.15.95	<p>The Permittee shall notify the MPCA of any of its industrial users that may be subject to National Categorical Pretreatment Standards. [Minn. R. 7049]</p>
5.15.96	<p>This permit may be modified in accordance with Minn. R. ch. 7001 to require development of a pretreatment program approvable under the Federal General Pretreatment Regulation (40 CFR 403). [Minn. R. 7049]</p>
Total Facility Requirements (NPDES/SDS)	
5.16.97	<p>Definitions. Refer to the Permit User's Manual found on the MPCA's website at https://www.pca.state.mn.us/sites/default/files/wq-wwtp7-09.pdf for standard definitions. [Minn. R. 7001]</p>
5.16.98	<p>Incorporation by Reference. This permit incorporates the following applicable federal and state laws as enforceable parts of this permit: 40 CFR pts. 122.41, 122.42, 136, 403 and 503; Minn. R. chs. 7001, 7041, 7045, 7050, 7052, 7053, 7060, and 7080; and Minn. Stat. chs. 115 and 116. [Minn. R. 7001]</p>
5.16.99	<p>Permittee Responsibility. The Permittee shall perform the actions or conduct the activities authorized by this permit in compliance with the conditions of the permit and, if required, in accordance with the plans and specifications approved by the MPCA. [Minn. R. 7001.0150, subp. 3(E)]</p>
5.16.100	<p>Toxic Discharges Prohibited. Whether or not this permit includes effluent limitations for toxic pollutants, the Permittee shall not discharge a toxic pollutant except according to 40 CFR pts. 400 to 460; Minn. R. chs. 7050, 7052, and 7053; and any other applicable MPCA rules. [Minn. R. 7001.1090, subp. 1(A)]</p>
5.16.101	<p>Nuisance Conditions Prohibited. The Permittee's discharge shall not cause any nuisance conditions including, but not limited to: floating solids, scum and visible oil film, excessive suspended solids, material discoloration, obnoxious odors, gas ebullition, deleterious sludge deposits, undesirable slimes or fungus growths, aquatic habitat degradation, excessive growths of aquatic plants, acutely toxic conditions to aquatic life, or other adverse impact on the receiving water. The discharge shall not cause a material discoloration in the receiving water. Any discharge that results in a discernable change to the existing/ambient color of the receiving water constitutes material discoloration. [Minn. R. 7050.0210, subp. 2]</p>
5.16.102	<p>Property Rights. This permit does not convey a property right or an exclusive privilege. [Minn. R. 7001.0150, subp. 3(C)]</p>

5.16.103	Liability Exemption. In issuing this permit, the State and the MPCA assume no responsibility for damage to persons, property, or the environment caused by the activities of the Permittee in the conduct of its actions, including those activities authorized, directed, or undertaken under this permit. To the extent the State and the MPCA may be liable for the activities of its employees, that liability is explicitly limited to that provided in the Tort Claims Act. [Minn. R. 7001.0150, subp. 3(O)]
5.16.104	The MPCA's issuance of this permit does not obligate the MPCA to enforce local laws, rules, or plans beyond what Minnesota statutes authorize. [Minn. R. 7001.0150, subp. 3(D)]
5.16.105	Liabilities. The MPCA's issuance of this permit does not release the Permittee from any liability, penalty, or duty imposed by Minnesota or federal statutes or rules or local ordinances, except the obligation to obtain the permit. [Minn. R. 7001.0150, subp. 3(A)]
5.16.106	The issuance of this permit does not prevent the future adoption by the MPCA of pollution control rules, standards, or orders more stringent than those now in existence and does not prevent the enforcement of these rules, standards, or orders against the Permittee. [Minn. R. 7001.0150, subp. 3(B)]
5.16.107	Severability. The provisions of this permit are severable and, if any provisions of this permit or the application of any provision of this permit to any circumstance are held invalid, the application of such provision to other circumstances and the remainder of this permit shall not be affected thereby. [Minn. R. 7001]
5.16.108	Compliance with Other Rules and Statutes. The Permittee shall comply with all applicable air quality, solid waste, and hazardous waste statutes and rules in the operation and maintenance of the facility. [Minn. R. 7001]
5.16.109	Inspection and Entry. When authorized by Minn. Stat. ch. 115.04, 115B.17, subd. 4, and 116.091, and upon presentation of proper credentials, the Permittee shall allow the MPCA, or an authorized employee or agent of the MPCA, to enter at reasonable times upon the property of the Permittee to examine and copy books, papers, records, or memoranda pertaining to the construction, modification, or operation of the facility covered by the permit or pertaining to the activity covered by the permit; and to conduct surveys and investigations, including sampling, monitoring, and other inspection equipment, pertaining to the construction, modification, or operation of the facility covered by the permit or pertaining to the activities covered by the permit. [Minn. R. 7001.0150, subp. 3(I)]
5.16.110	Control Users. The Permittee shall regulate the users of its facility to prevent the introduction of pollutants or materials that may result in the inhibition or disruption of the conveyance system, treatment facility or processes, or disposal system that would contribute to the violation of the conditions of this permit or any federal, state, or local law or regulation. [Minn. R. 7001.0150, subp. 3(F)]
5.16.111	Sampling. [Minn. R. 7001]
5.16.112	Representative Sampling. Sampling and measurements required by the permit shall be conducted as specified in the permit and shall be representative of the discharge or monitored activities. [Minn. R. 7001.0150, subp. 2(B)]
5.16.113	Additional Sampling. If the Permittee monitors more frequently than required, they shall report the results and the frequency of monitoring on their eDMR for that reporting period. [Minn. R. 7001.1090, subp. 1(E)]
5.16.114	Certified/Accredited Laboratory. A laboratory accredited by the Minnesota Department of Health [Minn. R. 4740.2010 through Minn. R. 4740.2120] and/or certified by the MPCA [Minn. R. 7001.4310 through Minn. R. 7001.4390] shall conduct analyses required by this permit, unless approved in writing by the MPCA. A certified/accredited laboratory does not need to complete analyses of dissolved oxygen, pH, temperature, specific conductance, and total residual oxidants (chlorine, bromine). Those analyses shall comply with 40 CFR pt. 136, including calibrations and the QA/QC section. Dissolved oxygen, pH, and total residual oxidants must be performed on-site. Follow the manufacturer's specifications for equipment maintenance and use. [Minn. R. 4740.2010-4740.2120, Minn. R. 7001.4310-7001.4390]

5.16.115	Sample Preservation and Procedure. Sample preservation and test procedures for the analysis of pollutants shall conform to 40 CFR pt. 136, including calibrations, the QA/QC section, and Minn. R. 7041.3200. Note - Table II of 40 CFR pt. 136.3 contains the requisite sample container, preservation (including, but not limited to thermal and pH adjustment), and holding times. [Minn. R. 7001.0150, subp. 2(B), Minn. R. 7041.3200]
5.16.116	Equipment Calibration. The Permittee shall check and/or calibrate flow meters, pumps, flumes, lift stations, or other flow monitoring equipment used for purposes of determining compliance (within plus or minus ten percent of the true flow values) with permit requirements at least twice annually. [Minn. R. 7001.0150, subp. 2(B & C)]
5.16.117	Maintain Records. The Permittee shall keep the records required by this permit for at least three years, including any calculations, original recordings from automatic monitoring instruments, and laboratory sheets. The Permittee shall extend these record retention periods upon request of the MPCA. The Permittee shall maintain records for each sample and measurement. The records shall include the following information: A. The exact place, date, and time of the sample or measurement; B. The date and time of analysis; C. The name of the person who performed the sample collection, measurement, analysis, or calculation; D. The analytical techniques, procedures, and methods used; and E. The results of the analysis. [Minn. R. 7001.0150, subp. 2(C)]
5.16.118	Completing Reports. The Permittee shall submit the results of the required sampling and monitoring activities on the forms provided, specified, or approved by the MPCA or as stipulated elsewhere in this permit. The Permittee shall record the information in the specified areas on those forms and in the units specified. Required forms may include a Sample Values Form. If required, the Permittee shall record individual values for each sample and measurement on the Sample Values Form provided by the MPCA. The Permittee shall submit the Sample Values Form with the appropriate eDMRs. The Permittee may design and use their own Sample Values Form after MPCA review and approval. Note: The Permittee shall also record required summary information on their eDMR. Permittee submitted summary information contained only on the Sample Values Form does not comply with reporting requirements. [Minn. R. 7001.0150, subp. 2(B), Minn. R. 7001.1090, subp. 1(D)]
5.16.119	Submitting Reports. The Permittee shall submit eDMRs, Sample Values Forms, and other supplemental attachment forms via MPCA e-Services after the MPCA approves their authorization request. The Permittee shall electronically submit eDMRs, Sample Values Forms, and other supplemental attachment forms by the 21st day of the month following the sampling period or otherwise as specified in this permit. The Permittee shall complete eDMR submittal on or before 11:59 p.m. of the 21st day of the month following the sampling period or as otherwise specified in this permit. The Permittee shall submit an eDMR for each required station even if no discharge occurred during the reporting period. The Permittee shall submit other reports required by this permit electronically. The Permittee shall submit reports by the date specified in this permit. The Permittee shall submit reports on or before 11:59 p.m. on the date specified in this permit. Electronically: wq.submittals.mPCA@state.mn.us Include water quality submittals form: www.pca.state.mn.us/sites/default/files/wq-wwprm7-71.docx . [Minn. R. 7001.0150, subp. 2(B), Minn. R. 7001.0150, subp. 3(H)]

5.16.120	Incomplete or Incorrect Reports. The Permittee shall immediately submit an electronically amended report or eDMR to the MPCA upon discovery by the Permittee or notification by the MPCA that it has submitted an incomplete or incorrect report or eDMR. The amended report or eDMR shall contain the missing or corrected data along with a comment on the eDMR explaining the circumstances of the incomplete or incorrect report. If it is impossible to amend the report or eDMR electronically, the Permittee shall immediately notify the MPCA and the MPCA will provide direction for the amendment submittals. [Minn. R. 7001.0150, subp. 3(G)]
5.16.121	Required Signatures. The Permittee or the duly authorized representative of the Permittee shall sign all eDMRs, forms, reports, and other documents submitted to the MPCA per Minn. R. 7001.0150, subp. 2(D). The person or persons who sign the eDMRs, forms, reports, or other documents shall certify that he or she understands and complies with the certification requirements of Minn. R. chs. 7001.0070 and 7001.0540, including the penalties for submitting false information. A registered professional engineer shall certify technical documents, such as design drawings and specifications, and engineering studies submitted as part of a permit application or by permit conditions. [Minn. R. 7001.0540]
5.16.122	Reporting Limit (RL). The Permittee shall report monitoring results below the RL of a particular instrument as "<" the value of the RL. For example, if an instrument has a RL of 0.1 mg/L and a parameter is not detected at a value of 0.1 mg/L or greater, the Permittee shall report the concentration as "< 0.1 mg/L." The Permittee shall not use "non-detected," "undetected," "below detection limit," or "zero" when reporting results. The MPCA considers these terms as permit reporting violations. Where sample values are less than the RL and the permit requires reporting of an average, the Permittee shall calculate the average as follows: A. If some values are less than (<) the RL, substitute zero for all non-detectable values to use in the average calculation; B. If all values are less than (<) the RL, calculate the average and report as < the RL average concentration; and C. To calculate a mass loading with a less than (<) the RL concentration, use the RL value in the calculation and then add the "<" to the product of the concentration and the volume. [Minn. R. 7001.0150, subp. 2(B)]
5.16.123	Records. The Permittee shall, when requested by the MPCA, submit within a reasonable time the information and reports that are relevant to the control of pollution regarding the construction, modification, or operation of the facility covered by the permit or regarding the conduct of the activities covered by the permit. [Minn. R. 7001.0150, subp. 3(H)]
5.16.124	Confidential Information. Except for data determined to be confidential according to Minn. Stat. ch. 116.075, subd. 2, all reports required by this permit are available for public inspection. The MPCA does not consider effluent data confidential. To request the MPCA maintain data as confidential, the Permittee shall follow Minn. R. 7000.1300. [Minn. R. 7000.1300]
5.16.125	Noncompliance and Enforcement. [Minn. R. 7001]
5.16.126	Subject to Enforcement Action and Penalties. Noncompliance with a term or condition of this permit subjects the Permittee to penalties provided by federal and state law set forth in section 309 of the Clean Water Act; United States Code, title 33, section 1319, as amended; and in Minn. Stat. ch. 115.071 and 116.072, including monetary penalties, imprisonment, or both. [Minn. R. 7001.1090, subp. 1(B)]
5.16.127	Criminal Activity. The Permittee shall not knowingly make a false statement, representation, or certification in a record or other document submitted to the MPCA. A person who falsifies a report or document submitted to the MPCA, or tampers with, or knowingly renders inaccurate a monitoring device or method that requires maintenance under this permit is subject to criminal and civil penalties provided by federal and state law. [Minn. R. 7001.0150, subp. 3(G), Minn. R. 7001.1090, subp. 1(G & H), Minn. Stat. ch. 609.671, subd. 1]

5.16.128	<p>Noncompliance Defense. It shall not be a defense for the Permittee in an enforcement action that it would have been necessary to halt or reduce the permitted activity in order to maintain compliance with the conditions of this permit. [40 CFR 122.41(c)]</p>
5.16.129	<p>Effluent Violations. If sampling by the Permittee indicates a violation of any discharge limitation specified in this permit, the Permittee shall immediately make every effort to verify the violation by collecting additional samples, if appropriate, investigate the cause of the violation, and take action to prevent future violations.</p> <p>If the Permittee discovers that noncompliance with a condition of the permit occurred and that the noncompliance could endanger human health, public drinking water supplies, or the environment, the Permittee shall within 24 hours of the discovery of the noncompliance orally notify the Commissioner and submit a written description of the noncompliance within five days of the discovery.</p> <p>If the Permittee discovers other noncompliance that does not explicitly endanger human health, public drinking water supplies, or the environment, the Permittee shall report the description of noncompliance within 30 days of the discovery. If no eDMR is required within 30 days, the Permittee shall submit a written report (see the Submitting Reports part of this chapter) including the description of noncompliance within 30 days of the discovery of the noncompliance. This description shall include the following information:</p> <ul style="list-style-type: none"> A. A description of the event including volume, duration, monitoring results, and receiving waters; B. The cause of the event; C. The steps taken to reduce, eliminate, and prevent reoccurrence of the event; D. The exact dates and times of the event; and E. Steps taken to reduce any adverse impact resulting from the event. [Minn. R. 7001.0150, subp. 3(K)]
5.16.130	<p>Upset Defense. In the event of temporary noncompliance with an applicable effluent limitation(s) resulting from an upset at the Permittee's facility due to factors beyond the control of the Permittee, the Permittee has an affirmative defense to an enforcement action brought by the MPCA as a result of the noncompliance if the Permittee demonstrates by a preponderance of competent evidence:</p> <ul style="list-style-type: none"> A. The specific cause of the upset; B. That the upset was unintentional; C. That the upset resulted from factors beyond the reasonable control of the Permittee and did not result from operational error, improperly designed treatment facilities, inadequate treatment facilities, lack of preventative maintenance, or increases in production which are beyond the design capability of the treatment facilities; D. That at the time of the upset the facility was being properly operated; E. That the Permittee properly notified the Commissioner of the upset in accordance with Minn. R. 7001.1090, subp. 1(I); and F. That the Permittee implemented the remedial measures required by Minn. R. 7001.0150, subp. 3(J). [Minn. R. 7001.1090]
5.16.131	<p>Release. [Minn. R. 7001]</p>
5.16.132	<p>Unauthorized Releases of Wastewater Prohibited. This permit prohibits overflows, discharges, spills, or other releases of wastewater or materials to the environment, whether intentional or not, except for discharges from outfalls specifically authorized by this permit. The MPCA will consider the Permittee's compliance with permit requirements, frequency of release, quantity, type, location, and other relevant factors when determining appropriate action. [Minn. Stat. ch. 115.061]</p>

5.16.133	<p>Discovery of a Release. Upon discovery of a release, the Permittee shall:</p> <p>A. Take all reasonable steps to immediately end the release;</p> <p>B. Notify the Minnesota Department of Public Safety Duty Officer at 800-422-0798 or 651-649-5451 (metro area) immediately upon discovery of the release. In addition to the required notification to the Duty Officer, the Permittee may also contact the MPCA during business hours at 800-657-3864 or 651-296-6300 (metro area);</p> <p>C. Promptly after notifying the agency of a discharge, a publicly owned treatment works or a publicly or privately owned domestic sewer system owner must provide notice to the potentially impacted public and to any downstream drinking water facility that may be impacted by the discharge. Notice to the public and to any drinking water facility must be made using the most efficient communications system available to the facility owner such as in person, telephone call, radio, social media, web page, or another expedited form. In addition, signage must be posted at all impacted public use areas within the same jurisdiction or notification must be provided to the entity that has jurisdiction over any impacted public use areas. A notice under this paragraph must include the date and time of the discharge, a description of the material released, a warning of the potential public health risk, and the permittee's contact information; and</p> <p>D. Recover as rapidly and as thoroughly as possible all substances and materials released or immediately take other action as may be reasonably possible to minimize or abate pollution to waters of the state or potential impacts to human health caused thereby. If the Permittee cannot immediately or completely recover the released materials or substances, the Permittee shall contact the MPCA. If directed by the MPCA, the Permittee shall consult with other local, state, or federal agencies (such as the Minnesota Department of Natural Resources and/or the Wetland Conservation Act authority) for implementation of additional clean up or remediation activities in wetland or other sensitive areas. [Minn. R. 7001.1090, Minn. Stat. ch. 115.061, subp. C]</p>
5.16.134	<p>Sampling of a Release. Upon discovery of a release, the Permittee shall:</p> <p>A. Collect representative samples of the release. The Permittee shall sample the release for permitted effluent parameters and other parameters of concern immediately following discovery of the release. The Permittee may contact the MPCA during business hours to discuss the sampling parameters and protocol. In addition, the Permittee shall collect fecal coliform bacteria samples where the Permittee determines that the release contains or may contain sewage. If the Permittee cannot immediately stop the release, the Permittee shall consult with the MPCA regarding additional sampling requirements. The Permittee shall collect samples at least, but not limited to, two times per week for as long as the release continues, or as stipulated elsewhere in this permit;</p> <p>B. The Permittee shall submit the Release Report information according to guidance found here: https://www.pca.state.mn.us/sites/default/files/wq-wwtp7-20a.docx. The Permittee shall submit the Release Report to the MPCA with the next eDMR or within 30 days, whichever is sooner. If the Permittee submits quarterly eDMRs and the next submittal is greater than 30 days, the Release Report may be submitted to the water quality submittals email address (see the Submitting Reports part of this chapter); and</p> <p>C. Submit the sampling results on the Release Report located on the MPCA's website at https://www.pca.state.mn.us/business-with-us/discharge-monitoring-reports. [Minn. R. 7001.1090]</p>
5.16.135	<p>Bypass. [Minn. R. 7001]</p>
5.16.136	<p>"Essential Maintenance" is a scheduled maintenance event that is required to ensure efficient operation of the facility. [Minn. R. 7001.1020, subp. 13]</p>
5.16.137	<p>"Effluent limitation" means a restriction established by rule or permit condition on quantities, discharge rates, and concentrations of pollutants that are discharged from point sources into waters of the state. [Minn. R. 7001.1020, subp. 13]</p>

5.16.138	<p>Anticipated Bypass. The Permittee may allow any bypass to occur that does not cause effluent limitation exceedances, but only if the bypass is for a scheduled essential maintenance event to assure efficient operation of the facility. The Permittee shall submit prior notice to the MPCA at least ten days before the date of the bypass, if possible. The notice of the need for an anticipated bypass shall include the following information:</p> <p>A. The proposed date and estimated duration of the bypass;</p> <p>B. The alternatives to bypassing; and</p> <p>C. A proposal for effluent sampling during the bypass. Any bypass wastewater shall enter waters of the state from outfalls specifically authorized by this permit. Therefore, the Permittee shall collect samples at the frequency and location identified in this permit or two times per week for as long as the bypass continues, whichever is more frequent. [Minn. R. 7001.1090, subp. 1(J)]</p>
5.16.139	<p>Any bypass that is not anticipated for a scheduled essential maintenance event is considered unanticipated and is prohibited. This permit prohibits all other bypasses.</p> <p>In the event of an unanticipated bypass, the Permittee shall:</p> <p>A. Take all reasonable steps to immediately end the bypass;</p> <p>B. Notify the Minnesota Department of Public Safety Duty Officer at 800-422-0798 or 651-649-5451 (metro area) immediately upon commencement of the bypass. In addition to the required notification to the Duty Officer, the Permittee may also contact the MPCA during business hours at 800-657-3864 or 651-296-6300 (metro area);</p> <p>C. Immediately take action as may be reasonably possible to minimize or abate pollution to waters of the state or potential impacts to human health caused thereby. If directed by the MPCA, the Permittee shall consult with other local, state, or federal agencies for implementation of abatement, clean up, or remediation activities; and</p> <p>D. The Permittee shall collect samples at the frequency and location identified in this permit or two times per week for as long as the bypass continues, whichever is more frequent. The Permittee shall also follow the reporting requirements for effluent violations as specified in this permit. [Minn. R. 7001.1090, subp. 1(K), Minn. Stat. ch. 115.061]</p>
5.16.140	<p>Notification of the Public. Following immediate notification to the Minnesota Department of Public Safety Duty Officer and the MPCA of any discharge event that could endanger human health, public drinking water supplies, or the environment, or a Release or Bypass, as described above, the Permittee shall promptly notify the public and any drinking water facility of the discharge.</p> <p>Notice to the public and to any drinking water facility must be made using the most efficient communications system available to the facility owner such as in person, telephone call, radio, social media, webpage, or another expedited form. In addition, signage must be posted at all impacted public use areas within the same jurisdiction or notification must be provided to the entity that has jurisdiction over any impacted public use areas. A notice under this requirement must include the date and time of the discharge, a description of the material released, a warning of the potential public health risk, and the Permittee's contact information. [Minn. Stat. ch. 115.061]</p>
5.16.141	<p>In addition to other facts or incidents required by the permit to be reported within 24 hours, the Permittee shall report in accordance with part 7001.0150, subpart 3, item K any unanticipated bypass, or upset that causes an exceedance of an applicable effluent limitation. [Minn. R. 7001.1090, subp. 1]</p>
5.16.142	<p>Operation and Maintenance. [Minn. R. 7001]</p>

5.16.143	The Permittee shall at all times properly operate and maintain the facilities, sewer system, and systems of treatment and control, and the appurtenances related to them which are installed or used by the Permittee to achieve compliance with the conditions of the permit. Proper operation and maintenance includes effective performance, adequate funding, adequate operator staffing and training, and adequate laboratory and process controls, including appropriate quality assurance procedures. The Permittee shall install and maintain appropriate backup or auxiliary facilities if they are necessary to achieve compliance with the conditions of the permit and, for all permits other than hazardous waste facility permits, if these backup or auxiliary facilities are technically and economically feasible. [Minn. R. 7001.0150, subp. 3(F)]
5.16.144	In the event of a reduction or loss of effective treatment of wastewater at the facility, the Permittee shall control production or curtail discharges to the extent necessary to maintain compliance with the terms and conditions of this permit. The Permittee shall continue this control or curtailment until they restore facility treatment processes or until the Permittee provides an alternative method of treatment. [Minn. R. 7001.1090, subp. 1(C)]
5.16.145	Solids Management. The Permittee shall properly store, transport, and manage biosolids, septage, sediments, residual solids, filter backwash, screenings, oil, grease, and other substances so that pollutants do not enter surface waters or groundwaters of the state. The Permittee shall manage solids in accordance with local, state, and federal requirements. [40 CFR 503, Minn. R. 7041]
5.16.146	Scheduled Maintenance. The Permittee shall schedule maintenance of the treatment works during non-critical water quality periods to prevent water quality degradation, except where the facility requires emergency maintenance to prevent a condition that would be detrimental to water quality or human health. [Minn. R. 7001.0150, subp. 2(B), Minn. R. 7001.0150, subp. 3(F)]
5.16.147	Control Tests. The Permittee shall conduct in-plant control tests at a frequency adequate to ensure compliance with the conditions of this permit. [Minn. R. 7001.0150, subp. 2(B), Minn. R. 7001.0150, subp. 3(F)]
5.16.148	Changes to the Facility or Permit. [Minn. R. 7001]
5.16.149	Permit Modifications. Except as provided under Minn. Stat. ch. 115.07, subd. 1 and 3, no person required by statute or rule to obtain a permit may construct, install, modify, or operate the facility to be permitted, nor shall a person commence an activity for which a permit is required by statute or rule until the MPCA issues a written permit for the facility or activity. Permittees that propose to make changes to the facility or discharge that requires permit modification shall follow Minn. R. 7001.0190. If the Permittee cannot determine whether the proposed changes require a permit modification, the Permittee shall contact the MPCA prior to any action. The MPCA recommends that Permittees submit the application for permit modification to the MPCA at least 180 days prior to the planned change. [Minn. R. 7001.0030]
5.16.150	This permit does not require plans, specifications, and MPCA approval when maintenance dictates the need for installation of new equipment, provided the equipment is the same design size and has the same design intent. For instance, Permittees can replace a broken pipe, lift station pump, aerator, or blower with the same design-sized equipment without MPCA approval. If this permit does not expressly authorize proposed construction, the MPCA may require a permit modification. If the proposed construction project requires an Environmental Assessment Worksheet under Minn. R. 4410, no construction shall begin until the MPCA issues a negative declaration and the Permittee receives or implements all approvals. [Minn. R. 7001.0030]
5.16.151	Report Changes. The Permittee shall give advance notice as soon as possible to the MPCA of any substantial changes in operational procedures, activities that may alter the nature or frequency of the discharge, and/or material factors that may affect compliance with the conditions of this permit. [Minn. R. 7001.0150, subp. 3(M)]

5.16.152	<p>Chemical Additives. The Permittee shall receive prior written approval from the MPCA before increasing the use of a chemical additive authorized by this permit, or using a chemical additive not authorized by this permit, in quantities or concentrations that have the potential to change the characteristics, nature, and/or quality of the discharge.</p> <p>The Permittee shall request approval for an increase or new use of a chemical additive at least 60 days, or as soon as possible, before the proposed increase or new use. The Permittee shall include at least the following information for the proposed additive as instructed in the chemical additive approvals section on the MPCA's website at https://www.pca.state.mn.us/business-with-us/wastewater-permit-additional-guidance-and-information (under Chemical additive approvals):</p> <p>A. Follow Chemical Additive Review Guidance (wq-prm2-12) and complete the Chemical Additive calculator tool (wq-wwprm2-12a.xlsm), including;</p> <p>B. The process for which the additive will be used;</p> <p>C. Safety Data Sheet (SDS) which shall include aquatic toxicity, human health, and environmental fate information for the proposed additive. The aquatic toxicity information shall include at minimum the results of: a) a 48-hour LC50 or EC50 acute study for a North American freshwater planktonic crustacean (such as Ceriodaphnia or Daphnia sp.) and b) a 96-hour LC50/EC50 acute study such as rainbow trout, bluegill, or fathead minnow or another North American freshwater aquatic species other than a planktonic crustacean;</p> <p>D. A complete product use and instruction label;</p> <p>E. The commercial and chemical names and Chemical Abstract Survey (CAS) number for all ingredients in the additive (If the SDS does not include information on chemical composition, including percentages for each ingredient totaling to 100%, the Permittee shall contact the supplier to have this information provided); and</p> <p>F. The proposed method of application, application frequency, and maximum rates of use.</p> <p>Upon review of the information submitted regarding the proposed chemical additive, the MPCA may require additional information be submitted for consideration. This permit may be modified to restrict the use or discharge of a chemical additive and include additional influent and effluent monitoring requirements. Approval for the use of an additive or use of an additive not requiring formal review and approval shall not justify the exceedance of any effluent limitation nor shall it be used as a defense against pollutant levels in the discharge causing or contributing to the violation of a water quality standard, including nuisance conditions and material discoloration. [Minn. R. 7001.0170]</p>
5.16.153	<p>MPCA-Initiated Permit Modification, Suspension, or Revocation. The MPCA may modify or revoke and reissue this permit pursuant to Minn. R. 7001.0170. The MPCA may revoke without reissuance of this permit pursuant to Minn. R. 7001.0180. [Minn. R. 7001.0170, Minn. R. 7001.0180]</p>
5.16.154	<p>Total Maximum Daily Load (TMDL) Impacts. The MPCA may require facilities that discharge to an impaired surface water, watershed, or drainage basin to comply with additional permits or permit requirements. These requirements can include additional restriction or relaxation of limits and monitoring as authorized by the CWA 303(d)(4)(A) and 40 CFR ch. 122.44(l)(2)(i), necessary to ensure consistency with the assumptions and requirements of any applicable EPA approved wasteload allocations resulting from TMDL studies. [40 CFR 122.44(l)(2)(i)]</p>
5.16.155	<p>Permit Transfer. This permit is not transferable to any person without the express written approval of the MPCA after compliance with the requirements of Minn. R. 7001.0190. A person who receives permit transference shall comply with the conditions of this permit. [Minn. R. 7001.0150, subp. 3(N)]</p>

5.16.156	<p>Facility Closure or Significant Reduction in Activity. The Permittee is responsible for closure and post-closure care of the facility. The Permittee shall notify the MPCA of a significant reduction or cessation of the activities described in this permit at least 180 days before the reduction or cessation. The Permittee may submit a Facility Closure Plan to the MPCA no later than 150 days prior to the Facility Closure, and the MPCA may require submittal of a Facility Closure Plan via written notification. The Permittee may comply with the submitted Facility Closure Plan.</p> <p>The MPCA may require a permit modification or reissuance for facility closure that could result in a potential long-term water quality concern, such as the ongoing discharge of wastewater to surface or groundwater.</p> <p>The MPCA may require the Permittee to establish and maintain financial assurance to ensure performance of certain obligations under this permit, including closure, post-closure care, and remedial action at the facility. If the MPCA requires financial assurance, the MPCA shall approve the amount and type of financial assurance, and proposed modifications to previously MPCA-approved financial assurance. [Minn. Stat. ch. 116.07, subd. 4]</p>
5.16.157	<p>Permit Reissuance. If the Permittee desires to continue permit coverage beyond the date of permit expiration, the Permittee shall submit an application for permit reissuance : Due by 180 days prior to permit expiration. [Minn. R. 7001.0040]</p>
5.16.158	<p>If the Permittee does not intend to continue the activities authorized by this permit after the expiration date of this permit, the Permittee shall notify the MPCA in writing at least 180 days before permit expiration. If the Permittee has submitted a timely application for permit reissuance, the Permittee may continue to conduct the activities authorized by this permit, in compliance with the requirements of this permit, until the MPCA takes final action on the application, unless the MPCA determines any of the following:</p> <ul style="list-style-type: none">A. The Permittee is not in substantial compliance with the requirements of this permit, or with a stipulation agreement or compliance schedule designed to bring the Permittee into compliance with this permit;B. The MPCA, as a result of an action or failure to act by the Permittee, has been unable to take final action on the application on or before the expiration date of the permit; orC. The Permittee has submitted an application with major deficiencies or has failed to properly supplement the application in a timely manner after being informed of deficiencies. [Minn. R. 7001.0040, Minn. R. 7001.0160]

7. Submittal action summary

GW 001	Well, Downgradient	
		Groundwater Well: Monitoring Requirements
	6.1.1	The Permittee shall submit a monthly DMR : Due by 21 days after the end of each calendar month following permit issuance. [Minn. R. 7001.0150, Subp. 2(B)]
GW 002	Well, Upgradient	
		Groundwater Well: Monitoring Requirements
	6.2.1	The Permittee shall submit a monthly DMR : Due by 21 days after the end of each calendar month following permit issuance. [Minn. R. 7001.0150, Subp. 2(B)]
GW 003	Well, Upgradient	
		Groundwater Well: Monitoring Requirements
	6.3.1	The Permittee shall submit a monthly DMR : Due by 21 days after the end of each calendar month following permit issuance. [Minn. R. 7001.0150, Subp. 2(B)]
GW 004	Well, Other	
		Groundwater Well: Monitoring Requirements
	6.4.1	The Permittee shall submit a monthly DMR : Due by 21 days after the end of each calendar month following permit issuance. [Minn. R. 7001.0150, Subp. 2(B)]
GW 005	Well, Downgradient	
		Groundwater Well: Monitoring Requirements
	6.5.1	The Permittee shall submit a monthly DMR : Due by 21 days after the end of each calendar month following permit issuance. [Minn. R. 7001.0150, Subp. 2(B)]
SD 001	Effluent To Surface Water	
		Surface Discharge: Minor Stabilization Pond Effluent Requirements
	6.6.1	The Permittee shall submit a monthly DMR : Due by 21 days after the end of each calendar month following permit issuance. [Minn. R. 7001.0150, subp. 2(B)]
WS 001	Influent Waste	
		Waste Stream: Stabilization Pond Influent Requirements
	6.7.1	The Permittee shall submit a monthly DMR : Due by 21 days after the end of each calendar month following permit issuance. [Minn. R. 7001.0150, subp. 2(B)]
WS 002	Intermediate: WW to Land	

Facility Specific Limit and Monitoring Requirements		
	6.8.1	The Permittee shall submit a monthly DMR : Due by 21 days after the end of each calendar month following permit issuance. [Minn. R. 7001.0150, Subp. 2(B)]
MN0022659	Atwater WWTF	
Total Facility Requirements (NPDES/SDS)		
	6.9.1	Permit Reissuance. If the Permittee desires to continue permit coverage beyond the date of permit expiration, the Permittee shall submit an application for permit reissuance : Due by 180 days prior to permit expiration. [Minn. R. 7001.0040]

DRAFT

8. Limits and monitoring

The Permittee shall comply with the limits and monitoring requirements as specified below.

Subject item	Parameter	Discharge limitations							Monitoring requirements			Notes	
		Quantity /Loading avg.	Quantity /Loading max.	Quantity /Loading units	Quality /Conc. min.	Quality /Conc. avg.	Quality /Conc. max.	Quality/ Conc. units	Frequency	Sample type	Effective period		
GW 001 Ground Water Well #1	Chloride, Total							Monitor only. calendar month maximum	milligrams per liter	once per month	Grab	Apr, Jul, Oct	
GW 001 Ground Water Well #1	Elevation of GW Relative to Mean Sea Level		Monitor only. instantaneous maximum	feet						once per month	Measurement, Instantaneous	Apr, Jul, Oct	
GW 001 Ground Water Well #1	Fecal Coliform, MPN or Membrane Filter 44.5C							Monitor only. calendar month maximum	organisms per 100 milliliter	once per month	Measurement, Instantaneous	Apr, Jul, Oct	
GW 001 Ground Water Well #1	Nitrite Plus Nitrate, Total (as N)							Monitor only. calendar month maximum	milligrams per liter	once per month	Grab	Apr, Jul, Oct	
GW 001 Ground Water Well #1	Nitrogen, Ammonia, Total (as N)							Monitor only. calendar month maximum	milligrams per liter	once per month	Grab	Apr, Jul, Oct	
GW 001 Ground Water Well #1	Nitrogen, Kjeldahl, Total							Monitor only. calendar month maximum	milligrams per liter	once per month	Grab	Apr, Jul, Oct	
GW 001 Ground Water Well #1	pH				Monitor only. instantaneous minimum			Monitor only. instantaneous maximum	standard units	once per month	Grab	Apr, Jul, Oct	

Subject item	Parameter	Discharge limitations						Monitoring requirements				Notes
		Quantity /Loading avg.	Quantity /Loading max.	Quantity /Loading units	Quality /Conc. min.	Quality /Conc. avg.	Quality /Conc. max.	Quality/ Conc. units	Frequency	Sample type	Effective period	
GW 001 Ground Water Well #1	Specific Conductance						Monitor only. instantaneous maximum	micromhos per cm	once per month	Grab	Apr, Jul, Oct	
GW 001 Ground Water Well #1	Temperature, Water (C)						Monitor only. instantaneous maximum	degrees Celsius	once per month	Grab	Apr, Jul, Oct	
GW 002 Ground Water Well #3	Elevation of GW Relative to Mean Sea Level		Monitor only. instantaneous maximum	feet					once per month	Measurement, Instantaneous	Apr, Jul, Oct	
GW 003 Ground Water Well #4	Chloride, Total						Monitor only. calendar month maximum	milligrams per liter	once per month	Grab	Apr, Jul, Oct	
GW 003 Ground Water Well #4	Elevation of GW Relative to Mean Sea Level		Monitor only. instantaneous maximum	feet					once per month	Measurement, Instantaneous	Apr, Jul, Oct	
GW 003 Ground Water Well #4	Fecal Coliform, MPN or Membrane Filter 44.5C						Monitor only. calendar month maximum	organisms per 100 milliliter	once per month	Grab	Apr, Jul, Oct	
GW 003 Ground Water Well #4	Nitrite Plus Nitrate, Total (as N)						Monitor only. calendar month maximum	milligrams per liter	once per month	Grab	Apr, Jul, Oct	
GW 003 Ground Water Well #4	Nitrogen, Ammonia, Total (as N)						Monitor only. calendar month maximum	milligrams per liter	once per month	Grab	Apr, Jul, Oct	

Subject item	Parameter	Discharge limitations						Monitoring requirements				Notes
		Quantity /Loading avg.	Quantity /Loading max.	Quantity /Loading units	Quality /Conc. min.	Quality /Conc. avg.	Quality /Conc. max.	Quality/ Conc. units	Frequency	Sample type	Effective period	
GW 003 Ground Water Well #4	Nitrogen, Kjeldahl, Total						Monitor only. calendar month maximum	milligrams per liter	once per month	Grab	Apr, Jul, Oct	
GW 003 Ground Water Well #4	pH				Monitor only. instantaneous minimum		Monitor only. instantaneous maximum	standard units	once per month	Grab	Apr, Jul, Oct	
GW 003 Ground Water Well #4	Specific Conductance						Monitor only. instantaneous maximum	micromhos per cm	once per month	Grab	Apr, Jul, Oct	
GW 003 Ground Water Well #4	Temperature, Water (C)						Monitor only. instantaneous maximum	degrees Celsius	once per month	Grab	Apr, Jul, Oct	
GW 004 Existing Well	Chloride, Total						Monitor only. calendar month maximum	milligrams per liter	once per month	Grab	Apr, Jul, Oct	
GW 004 Existing Well	Elevation of GW Relative to Mean Sea Level		Monitor only. instantaneous maximum	feet					once per month	Measurement, Instantaneous	Apr, Jul, Oct	
GW 004 Existing Well	Fecal Coliform, MPN or Membrane Filter 44.5C						Monitor only. calendar month maximum	organisms per 100 milliliter	once per month	Grab	Apr, Jul, Oct	
GW 004 Existing Well	Nitrite Plus Nitrate, Total (as N)						Monitor only. calendar month maximum	milligrams per liter	once per month	Grab	Apr, Jul, Oct	

Subject item	Parameter	Discharge limitations						Monitoring requirements				Notes
		Quantity /Loading avg.	Quantity /Loading max.	Quantity /Loading units	Quality /Conc. min.	Quality /Conc. avg.	Quality /Conc. max.	Quality/ Conc. units	Frequency	Sample type	Effective period	
GW 004 Existing Well	Nitrogen, Ammonia, Total (as N)						Monitor only. calendar month maximum	milligrams per liter	once per month	Grab	Apr, Jul, Oct	
GW 004 Existing Well	Nitrogen, Kjeldahl, Total						Monitor only. calendar month maximum	milligrams per liter	once per month	Grab	Apr, Jul, Oct	
GW 004 Existing Well	pH				Monitor only. instantaneous minimum		Monitor only. instantaneous maximum	standard units	once per month	Grab	Apr, Jul, Oct	
GW 004 Existing Well	Specific Conductance						Monitor only. instantaneous maximum	micromhos per cm	once per month	Grab	Apr, Jul, Oct	
GW 004 Existing Well	Temperature, Water (C)						Monitor only. instantaneous maximum	degrees Celsius	once per month	Grab	Apr, Jul, Oct	
GW 005 Ground Water Well #5	Chloride, Total						Monitor only. calendar month maximum	milligrams per liter	once per month	Grab	Apr, Jul, Oct	
GW 005 Ground Water Well #5	Elevation of GW Relative to Mean Sea Level		Monitor only. instantaneous maximum	feet					once per month	Measurement, Instantaneous	Apr, Jul, Oct	
GW 005 Ground Water Well #5	Fecal Coliform, MPN or Membrane Filter 44.5C						Monitor only. calendar month maximum	organisms per 100 milliliter	once per month	Grab	Apr, Jul, Oct	
GW 005 Ground Water Well #5	Nitrite Plus Nitrate, Total (as N)						Monitor only. calendar month maximum	milligrams per liter	once per month	Grab	Apr, Jul, Oct	

Subject item	Parameter	Discharge limitations						Monitoring requirements				Notes
		Quantity /Loading avg.	Quantity /Loading max.	Quantity /Loading units	Quality /Conc. min.	Quality /Conc. avg.	Quality /Conc. max.	Quality/ Conc. units	Frequency	Sample type	Effective period	
GW 005 Ground Water Well #5	Nitrogen, Ammonia, Total (as N)						Monitor only. calendar month maximum	milligrams per liter	once per month	Grab	Apr, Jul, Oct	
GW 005 Ground Water Well #5	Nitrogen, Kjeldahl, Total						Monitor only. calendar month maximum	milligrams per liter	once per month	Grab	Apr, Jul, Oct	
GW 005 Ground Water Well #5	pH				Monitor only. instantaneous minimum		Monitor only. instantaneous maximum	standard units	once per month	Grab	Apr, Jul, Oct	
GW 005 Ground Water Well #5	Specific Conductance						Monitor only. instantaneous maximum	micromhos per cm	once per month	Grab	Apr, Jul, Oct	
GW 005 Ground Water Well #5	Temperature, Water (C)						Monitor only. instantaneous maximum	degrees Celsius	once per month	Grab	Apr, Jul, Oct	
SD 001 Total Facility Discharge	BOD, Carbonaceous 05 Day (20 Deg C)	115 calendar month average	185 maximum calendar week average	kilograms per day		25 calendar month average	40 maximum calendar week average	milligrams per liter	twice per week	Grab	Jan-Dec	
SD 001 Total Facility Discharge	Fecal Coliform, MPN or Membrane Filter 44.5C					200 calendar month geometric mean		organisms per 100 milliliter	twice per week	Grab	Apr-Oct	

Subject item	Parameter	Discharge limitations						Monitoring requirements				Notes
		Quantity /Loading avg.	Quantity /Loading max.	Quantity /Loading units	Quality /Conc. min.	Quality /Conc. avg.	Quality /Conc. max.	Quality/ Conc. units	Frequency	Sample type	Effective period	
SD 001 Total Facility Discharge	Flow		Monitor only. calendar month total intervention	million gallons		Monitor only. calendar month average intervention	Monitor only. calendar month max intervention limit	million gallons per day	once per day	Measurement, Continuous	Jan-Feb, Jul, Aug	The intervention limit is 0 MG. If this limit is exceeded, the Permittee must take action as described in the Ponds - Discharge Outside of Acceptable Discharge Periods section of the permit.
SD 001 Total Facility Discharge	Flow		Monitor only. calendar month total	million gallons		Monitor only. calendar month average	Monitor only. calendar month maximum	million gallons per day	once per day	Measurement, Continuous	Mar-Jun, Sep-Dec	Discharge Window: Mar 1-June 15, September 15 -Dec 31
SD 001 Total Facility Discharge	Mercury, Dissolved (as Hg)						Monitor only. calendar year maximum	nanograms per liter	once per year	Grab	Jan-Dec	
SD 001 Total Facility Discharge	Mercury, Total (as Hg)						Monitor only. calendar year maximum	nanograms per liter	once per year	Grab	Jan-Dec	
SD 001 Total Facility Discharge	Nitrite Plus Nitrate, Total (as N)					Monitor only. calendar month average		milligrams per liter	once per month	Grab	Jan-Dec	
SD 001 Total Facility Discharge	Nitrogen, Ammonia, Total (as N)					Monitor only. calendar month average		milligrams per liter	once per half year	Grab	Jan-Dec	

Subject item	Parameter	Discharge limitations							Monitoring requirements			Notes
		Quantity /Loading avg.	Quantity /Loading max.	Quantity /Loading units	Quality /Conc. min.	Quality /Conc. avg.	Quality /Conc. max.	Quality/ Conc. units	Frequency	Sample type	Effective period	
SD 001 Total Facility Discharge	Nitrogen, Kjeldahl, Total					Monitor only. calendar month average		milligrams per liter	once per month	Grab	Jan-Dec	
SD 001 Total Facility Discharge	Nitrogen, Total (as N)					Monitor only. calendar month average		milligrams per liter	once per month	Calculation	Jan-Dec	
SD 001 Total Facility Discharge	Oxygen, Dissolved				Monitor only. calendar month minimum			milligrams per liter	twice per week	Grab	Jan-Dec	
SD 001 Total Facility Discharge	pH				6.0 calendar month minimum		9.0 calendar month maximum	standard units	twice per week	Grab	Jan-Dec	
SD 001 Total Facility Discharge	Phosphorus, Total (as P)		553 calendar year to date total	kilograms per year					once per month	Calculation	Jan-Dec	
SD 001 Total Facility Discharge	Phosphorus, Total (as P)	Monitor only. calendar month average		kilograms per day		Monitor only. calendar month average		milligrams per liter	twice per week	Grab	Oct- May	
SD 001 Total Facility Discharge	Phosphorus, Total (as P)	0.52 calendar month average		kilograms per day		Monitor only. calendar month average		milligrams per liter	twice per week	Grab	Jun-Sep	

Subject item	Parameter	Discharge limitations						Monitoring requirements				Notes
		Quantity /Loading avg.	Quantity /Loading max.	Quantity /Loading units	Quality /Conc. min.	Quality /Conc. avg.	Quality /Conc. max.	Quality/ Conc. units	Frequency	Sample type	Effective period	
SD 001 Total Facility Discharge	Solids, Total Dissolved (TDS)					Monitor only. calendar month average		milligrams per liter	once per half year	Grab	Jan-Dec	
SD 001 Total Facility Discharge	Solids, Total Suspended (TSS)	208 calendar month average	300 maximum calendar week average	kilograms per day		45 calendar month average	65 maximum calendar week average	milligrams per liter	twice per week	Grab	Jan-Dec	
SD 001 Total Facility Discharge	Solids, Total Suspended (TSS), grab (Mercury)						Monitor only. calendar year maximum	milligrams per liter	once per year	Grab	Jan-Dec	
SD 001 Total Facility Discharge	Sulfate, Total (as SO4)						Monitor only. calendar month maximum	milligrams per liter	once per half year	Grab	Jan-Dec	
WS 001 Influent Waste Stream	BOD, Carbonaceous 05 Day (20 Deg C)					Monitor only. calendar quarter average		milligrams per liter	once per quarter	4-Hour Flow Composite	Mar, Jun, Sep, Dec	
WS 001 Influent Waste Stream	Flow		Monitor only. calendar month total	million gallons		Monitor only. calendar month average	Monitor only. calendar month maximum	million gallons per day	once per day	Measurement, Continuous	Jan-Dec	
WS 001 Influent Waste Stream	Nitrite Plus Nitrate, Total (as N)					Monitor only. calendar quarter average		milligrams per liter	once per quarter	4-Hour Flow Composite	Mar, Jun, Sep, Dec	

Subject item	Parameter	Discharge limitations							Monitoring requirements			Notes
		Quantity /Loading avg.	Quantity /Loading max.	Quantity /Loading units	Quality /Conc. min.	Quality /Conc. avg.	Quality /Conc. max.	Quality/ Conc. units	Frequency	Sample type	Effective period	
WS 001 Influent Waste Stream	Nitrogen, Kjeldahl, Total					Monitor only. calendar quarter average		milligrams per liter	once per quarter	4-Hour Flow Composite	Mar, Jun, Sep, Dec	
WS 001 Influent Waste Stream	Nitrogen, Total (as N)					Monitor only. calendar quarter average		milligrams per liter	once per quarter	Calculation	Mar, Jun, Sep, Dec	
WS 001 Influent Waste Stream	pH						Monitor only. calendar quarter maximum	standard units	once per quarter	Grab	Mar, Jun, Sep, Dec	
WS 001 Influent Waste Stream	Phosphorus, Total (as P)					Monitor only. calendar quarter average		milligrams per liter	once per quarter	4-Hour Flow Composite	Mar, Jun, Sep, Dec	
WS 001 Influent Waste Stream	Precipitation		Monitor only. calendar month total	inches					once per day	Measurement	Jan-Dec	
WS 001 Influent Waste Stream	Solids, Total Suspended (TSS)					Monitor only. calendar quarter average		milligrams per liter	once per quarter	4-Hour Flow Composite	Mar, Jun, Sep, Dec	
WS 002 Effluent to Cell C	Chloride, Total					Monitor only. calendar month average		milligrams per liter	twice per week	Grab	Jan-Dec	

Subject item	Parameter	Discharge limitations							Monitoring requirements			Notes
		Quantity /Loading avg.	Quantity /Loading max.	Quantity /Loading units	Quality /Conc. min.	Quality /Conc. avg.	Quality /Conc. max.	Quality/ Conc. units	Frequency	Sample type	Effective period	
WS 002 Effluent to Cell C	Flow		Monitor only. calendar month total	million gallons		Monitor only. calendar month average	Monitor only. calendar month maximum	million gallons per day	twice per week	Measurement, Continuous	Jan-Dec	
WS 002 Effluent to Cell C	Nitrite Plus Nitrate, Total (as N)					Monitor only. calendar month average		milligrams per liter	twice per week	Grab	Jan-Dec	
WS 002 Effluent to Cell C	Nitrogen, Kjeldahl, Total					Monitor only. calendar month average		milligrams per liter	twice per week	Grab	Jan-Dec	
WS 002 Effluent to Cell C	Nitrogen, Total (as N)					Monitor only. calendar month average		milligrams per liter	twice per week	Surrogate Spike	Jan-Dec	
WS 002 Effluent to Cell C	pH				Monitor only. calendar month minimum		Monitor only. calendar month maximum	standard units	twice per week	Grab	Jan-Dec	
WS 002 Effluent to Cell C	Solids, Total Suspended (TSS)					Monitor only. calendar month average		milligrams per liter	twice per week	Grab	Jan-Dec	